



exterior perspective view 1



exterior perspective view 2

highfields village

*power homes*

*minimising the impact on the environment*

H I G H F I E L D S  
 Protect Our World Environment Resources

- 5 star (+40%) Energy Efficiency Rating
- Low operational costs
- Affordable ESD features
- Building orientation recognises best positioning of house on block to achieve optimum thermal efficiencies and prevailing winds

location



locality plan



the site



PRESENTATION PURPOSES ONLY. THIS DRAWING MAY NOT REPLACE THE FINISHED PRODUCT AND INDICATES DESIGN INTENT ONLY. LAGDER PTY LTD. DOES NOT ACCEPT ANY RESPONSIBILITY FOR CHANGES BETWEEN THE DRAWING AND THE FINISHED PRODUCT.



## water conservation

AAA rated dual flush toilet systems  
4 star Hansa **water saving** plumbing fixtures throughout  
Enviro Save Water System

## sustainable materials laminates

Substrate board achieves a low formaldehyde emission - **E1 rating**  
Manufacturer committed to waste + emission reduction, resource conservation, recycling + sustainable development

## paint

Unique **low odour** paint  
99.7% VOC (Volatile Organic Compound)  
free acrylic paint  
Excellent flow and levelling resulting in a smoother finish

## carpet flooring

**100% Wool** - Australian made  
Manufacturer awarded '2005 Savewater Award' for outstanding achievement in water conservation  
Carpet complies with the Carpet and Rug Institute Green Label Plus Program

## bamboo flooring

**Environmentally friendly** + sustainable product  
Renewable resource + 5 year growth cycle  
Hardwearing + extremely **durable**  
Non-toxic + waste free manufacturing  
Resistant to white ants as well as fire and sunlight

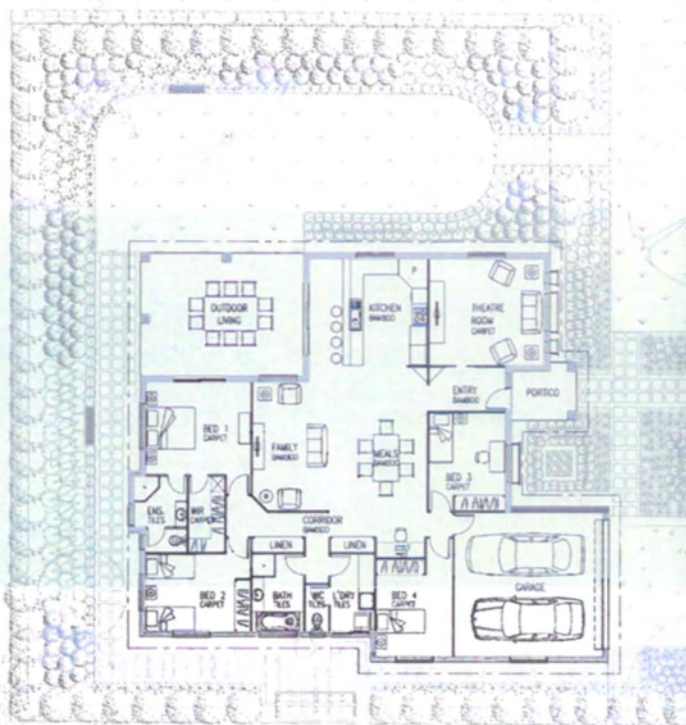

environmental

H I G H F I E L D S  
H O M E S  
Protect Our World Environment Resources

## roof insulation

**Roof:** 55mm thick glasswool insulation blanket with integral reflective foil sisalation with R2.0 rating. CSR Braford Anticon 55 or similar.  
**Ceiling:** 140mm thick glasswool insulation batts with R1.5 rating minimum. CSR Bradford 140mm Comfort-Seal Ceiling Batts.  
**External Walls:** 75mm thick glasswool insulation batts with R1.5 rating min. and reflective foil sarking. CSR Bradford 75mm ComfortSeal wall batts.

## solar electric boost HWS

R2701. tank with two Streamline Solar panels and electric booster

## in ground Manacon 25000l. tank

25000l in ground Manacon concrete tank, locally manufactured  
Davey pump and Rainbank pump and filters  
Dual supply to laundry, dishwasher, WC's + external tap

highfields village

power homes

minimising the impact on the environment



PRESENTATION PURPOSES ONLY. THIS DRAWING MAY NOT REFLECT THE FINISHED PRODUCT AND INDICATES DESIGN INTENT ONLY. LAUGHER PTY LTD. DOES NOT ACCEPT ANY RESPONSIBILITY FOR CHANGES BETWEEN THE DRAWING AND THE FINISHED PRODUCT.

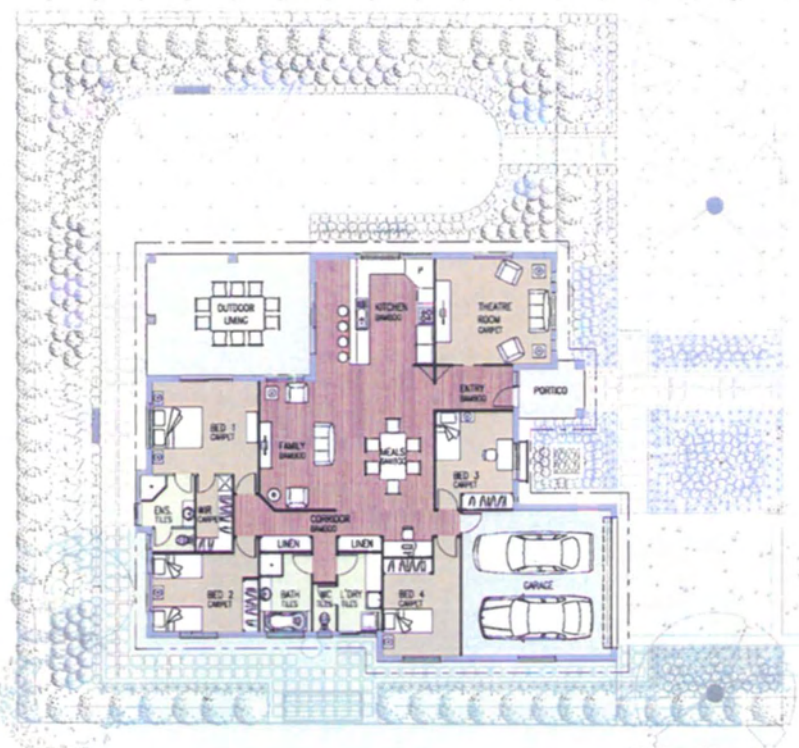

floor plan

# highfields village

power homes  
 minimising the impact on the environment

# finishes



exterior  
 roofing, fascia + render



paint finish  
 general wall, feature wall



laminate, wall tile  
 bathroom vanity



floor tile  
 bathroom, laundry



laminate, wall tile  
 kitchen splashback



bamboo flooring  
 general living



carpet  
 bedrooms



PRESENTATION PURPOSES ONLY. THIS DRAWING MAY NOT REFLECT THE FINISHED PRODUCT AND INDICATES DESIGN INTENT ONLY. LAUDER PTY LTD. DOES NOT ACCEPT ANY RESPONSIBILITY FOR CHANGES BETWEEN THE DRAWING AND THE FINISHED PRODUCT.

